

BTN

ER 筒夾刀把 ER COLLET CHUCK



Balancing / 動平衡

Dimensions / 尺寸標示

G6.3

Max.30,000 RPM
Or U ≤ 1gmm

Option / 選配
G2.5

Max.30,000 RPM
Or U ≤ 1gmm

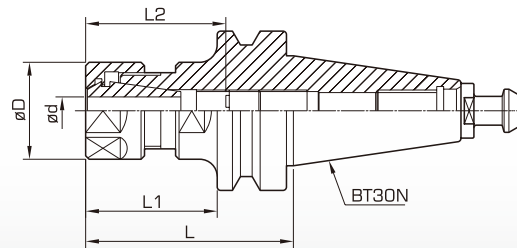

BTN BTN HOLDER WITHOUT KEYWAY

page.146

page.144

page.120

page.148



Order No. 訂購編號	Range ϕd 夾持範圍	ϕD	L	L1	Tool Clamping Depth L2 刀具夾持深度	page.146				page.144		page.120		page.148	
						Nut 螺帽	Screw 調整螺絲	Collet 筒夾	Wrench 扳手						
BT30N	ER16-060	0.6~10.0	28	60	38	29~58	CAP-ER16	ER-M11	ER16	PHS-ER16					
	ER20-060	0.6~13.0	34	60	38	32~63	CAP-ER20	ER-M14	ER20	PHS-ER20					
	ER25-075	0.6~16.0	42	75	53	35~78	CAP-ER25	ER-M18	ER25	PHS-ER25					

Remarks / 備註

- 若需出水型刀把，請參考 page.26 選用說明

Applications / 應用



Drilling
鑽孔



Endmilling
銑削



Tapping
攻牙