

Extension Bar

ER 鋼珠螺帽延長桿 ER EXTENSION BAR WITH BEARING NUT

Dimensions / 尺寸標示

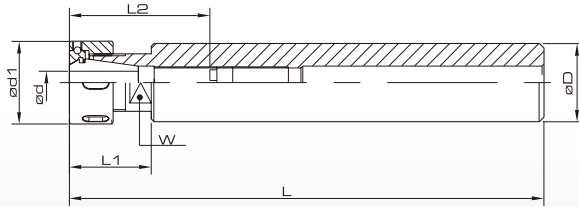

page.146

page.144

page.120

page.148



Nut
螺帽

Screw
調整螺絲

Collet
筒夾

Wrench
扳手

Order No. 訂購編號	Range 夾持範圍	ød	øD	ød1	L	L1	L2	W				
ASSA16	ER11-105B	1.0~7.0	16	23.5	105	25	20~50	13	CAP-ER11B	ER-M8	ER11-HP	PHS-ER11B
ASSA20	ER11-125B	1.0~7.0	20	23.5	125	25	20~50	13	CAP-ER11B	ER-M8	ER11-HP	PHS-ER11B
	ER16-135B	1.0~10.0	20	32	135	35	29~60	19	CAP-ER16B	ER-M11	ER16-HP	PHS-ER16B
ASSA25	ER16-155B	1.0~10.0	25	32	155	35	29~60	19	CAP-ER16B	ER-M11	ER16-HP	PHS-ER16B
	ER20-156B	1.0~13.0	25	36	156	36	33~70	21	CAP-ER20B	ER-M14	ER20-HP	PHS-ER20B
ASSA32	ER20-186B	1.0~13.0	32	36	186	36	33~70	21	CAP-ER20B	ER-M14	ER20-HP	PHS-ER20B
	ER25-200B	1.0~16.0	32	43	200	50	37~80	27	CAP-ER25B	ER-M18	ER25-HP	PHS-ER25

Applications / 應用



Drilling
鑽孔



Reaming
鉸孔



Endmilling
銑削



Tapping
攻牙

ER 標準螺帽延長桿 ER EXTENSION BAR

Dimensions / 尺寸標示

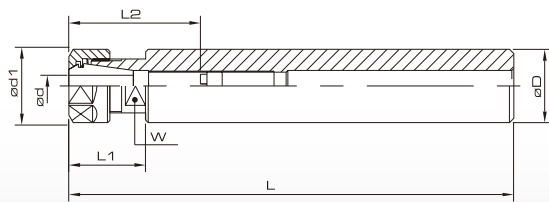

page.146

page.144

page.120

page.148



Nut
螺帽

Screw
調整螺絲

Collet
筒夾

Wrench
扳手

Order No. 訂購編號	Range 夾持範圍	ød	øD	ød1	L	L1	L2	W				
ASSA16	ER11-105	0.6~7.0	16	19	105	25	20~50	13	CAP-ER11	ER-M8	ER11	PHS-ER11
ASSA20	ER11-125	0.6~7.0	20	19	125	25	20~50	13	CAP-ER11	ER-M8	ER11	PHS-ER11
	ER16-135	0.6~10.0	20	28	135	35	29~60	19	CAP-ER16	ER-M11	ER16	PHS-ER16
ASSA25	ER16-155	0.6~10.0	25	28	155	35	29~60	19	CAP-ER16	ER-M11	ER16	PHS-ER16
	ER20-156	0.6~13.0	25	34	156	36	33~70	21	CAP-ER20	ER-M14	ER20	PHS-ER20
ASSA32	ER20-186	0.6~13.0	32	34	186	36	33~70	21	CAP-ER20	ER-M14	ER20	PHS-ER20
	ER25-200	0.6~16.0	32	42	200	50	37~80	27	CAP-ER25	ER-M18	ER25	PHS-ER25

Applications / 應用



Drilling
鑽孔



Endmilling
銑削



Tapping
攻牙